

**Ownership / Legal Information**

<b>Locator ID</b> 24L310573	<b>Tax Year</b> 2009	<b>Tax District</b> 134U	<b>City Code</b> 064	<b>Site Code</b> 1471	<b>Destination Code</b>
<b>Owner:</b>	Cuniberti Betty				
<b>Taxing Address:</b>	353 Linum Ln Saint Louis, MO 63119				
<b>Care-Of Name:</b>					
<b>Mailing Address:</b>	Same as taxing address.				
<b>Sub. Book &amp; Page:</b>					
<b>Assessor's Book &amp; Page:</b>	04 0346 A				
<b>City Code - Name:</b>	064 - Webster Groves	<b>Trash District No.</b>			
<b>Subdivision:</b>	Webster Ridge Plat 8				
<b>Legal Description:</b>	Lot Pt 124 W Pt				
<b>Roll - Frame:</b>	13976 0312				
<b>Lot No.</b>		<b>Block No.</b>			
<b>Lot Dimensions:</b>	0072/0072 0145/0145	<b>Acres:</b>			
<b>Recorder's Date &amp; Daily:</b>	2002071201670	<b>Deed Type:</b>	WD		
<b>Taxing Code:</b>	A - Taxable	<b>Land Use Code:</b>	110		
<b>Deed Information:</b>	<a href="#">Locator Deed Search Information</a>				

**Note:** The information on this site was last refreshed on .

**Assessment Information**

**Estimates of value are preliminary until the tax certification date July 1.**

**Values are still being reviewed and are subject to change.**

[Assessor's Comparable Sales](#)

[Other Sales In Your Area](#)

<b>CURRENT</b>	<b>Appraised</b>					<b>Assessed</b>		
<b>Tax Year: 2009</b>	<b>Land</b>	<b>Improv.</b>	<b>Total</b>	<b>%</b>	<b>Land</b>	<b>Improv.</b>	<b>Total</b>	
<b>Residential:</b>	48,200	134,000	182,200	19%	9,160	25,460	34,620	
<b>Agricultural:</b>	0	0	0	12%	0	0	0	
<b>Commercial:</b>	0	0	0	32%	0	0	0	
<b>Total:</b>	48,200	134,000	182,200		9,160	25,460	34,620	

<b>PREVIOUS</b>	<b>Appraised</b>					<b>Assessed</b>		
<b>Tax Year: 2008</b>	<b>Land</b>	<b>Improv.</b>	<b>Total</b>	<b>%</b>	<b>Land</b>	<b>Improv.</b>	<b>Total</b>	
<b>Residential:</b>	48,200	155,700	203,900	19%	9,160	29,580	38,740	

<b>Agricultural:</b>	0	0	0	12%	0	0	0
<b>Commercial:</b>	0	0	0	32%	0	0	0
<b>Total:</b>	48,200	155,700	203,900		9,160	29,580	38,740

[How To Appeal The Value Of Your House](#) 

[Other Helpful Informational Brochures](#)

[Assessment FAQs](#)

### Dwelling Information

<b>Locator ID: 24L310573</b>		<b>Tax Year: 2009</b>		<b>Card: 1</b>		<b>Living Units: 1</b>	
<b>Stories:</b>	<b>1</b>	<b>External Wall:</b>	<b>Alum / Vinyl</b>				
<b>Style:</b>	<b>Ranch</b>	<b>Year Built:</b>	<b>1951</b>				
<b>Eff. Year:</b>		<b>Remodeled:</b>					
<b>Total Rooms:</b>	<b>6</b>	<b>Total Bedrooms:</b>	<b>3</b>				
<b>Full / Half Bath:</b>	<b>2 / 0</b>	<b>Total Fixtures</b>	<b>8</b>				
<b>Remodeled Kit:</b>		<b>Remodeled Bath:</b>					
<b>Basement:</b>	<b>Full</b>	<b>Heat:</b>	<b>Central w/ AC</b>				
<b>Basement Garage:</b>							
<b>Fuel:</b>	<b>Gas</b>	<b>Heat System:</b>	<b>Warm Air</b>				
<b>Attic:</b>	<b>None</b>	<b>Int / Ext Condition:</b>	<b>Same</b>				
<b>Rec Room Area:</b>	<b>200</b>	<b>Finished Basement Area:</b>					
<b>Wood Fireplace / Stacks:</b>	<b>1 / 1</b>	<b>Metal Fireplace:</b>					
<b>Ground Floor Area:</b>	<b>1104</b>	<b>Total Living Area:</b>	<b>1104</b>				
<b>Grade:</b>	<b>C</b>	<b>C.D.U.</b>	<b>VG</b>				

### Sales Information

Sales Date	Book/Page	Sale Price	Type
9/1/1983		\$75,000	Land & Building
10/1/1987		\$102,900	Land & Building
6/1/1991		\$91,800	Land & Building
11/1/1995		\$123,900	Land & Building
7/12/2002	13976 0312	\$195,000	Land & Building

No OB & Y Associated With Card 1.

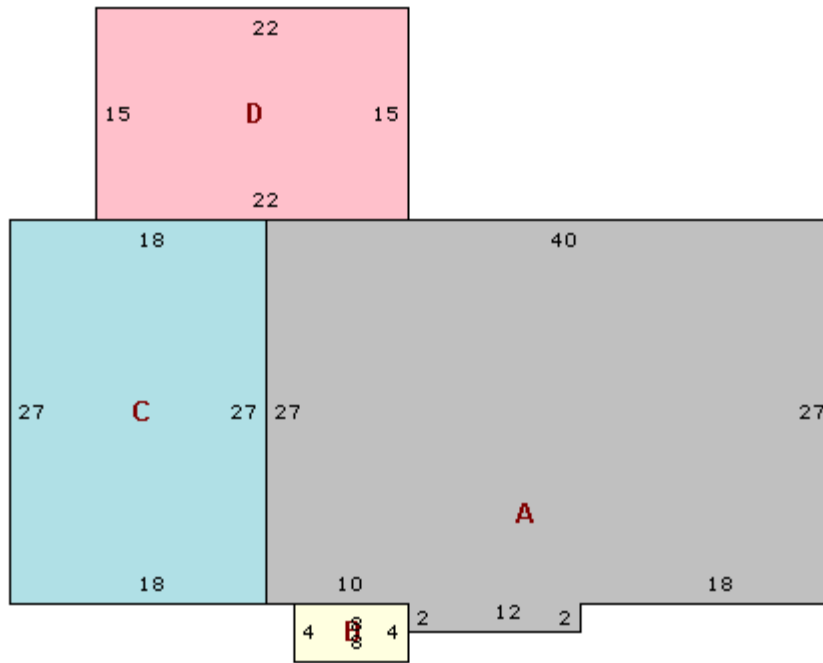

Locator ID: **24L310573**

Card: **1**

353 LINUM LN, SAINT LOUIS, MO 63119

Key	Area	Description	Floor
<b>A</b>	<b>1104</b>	<b>Main Dwelling: Alum / Vinyl</b> <b>Stories: 1</b> <b>Basement: Full</b>	
<b>B</b>	<b>32</b>	<b>Stoop</b>	<b>First</b>
<b>C</b>	<b>486</b>	<b>Frame Garage</b>	<b>First</b>
<b>D</b>	<b>330</b>	<b>Wood Deck</b>	<b>First</b>

TLA: **1104**

As a service to the public, the St. Louis County Assessor's office is pleased to present the information on this web site. We have tried to ensure that the information provided is as accurate as possible. The Assessor's Office makes no warranty or guarantee concerning the accuracy or reliability of the content at this site or at other sites which are linked to ours. Assessing accuracy and reliability of information is the responsibility of the user. The Assessor's Office shall not be liable for errors contained herein or for any damages in connection with the use of the information contained herein.